

THIS DRAWING IS TO BE READ IN CONJUNCTION WITH ALL RELATED DRAWINGS. ALL DIMENSIONS MUST BE CHECKED AND VERIFIED ON SITE BEFORE COMMENCING ANY WORK OR PRODUCING SHOP DRAWINGS. THE ORIGINATOR SHOULD BE NOTIFIED IMMEDIATELY OF ANY DISCREPANCY. THIS DRAWING IS COPYRIGHT AND REMAINS THE PROPERTY ROGER PARRY & PARTNERS.

Rev	Description	Date	By
-	-	year/mm/dd	--

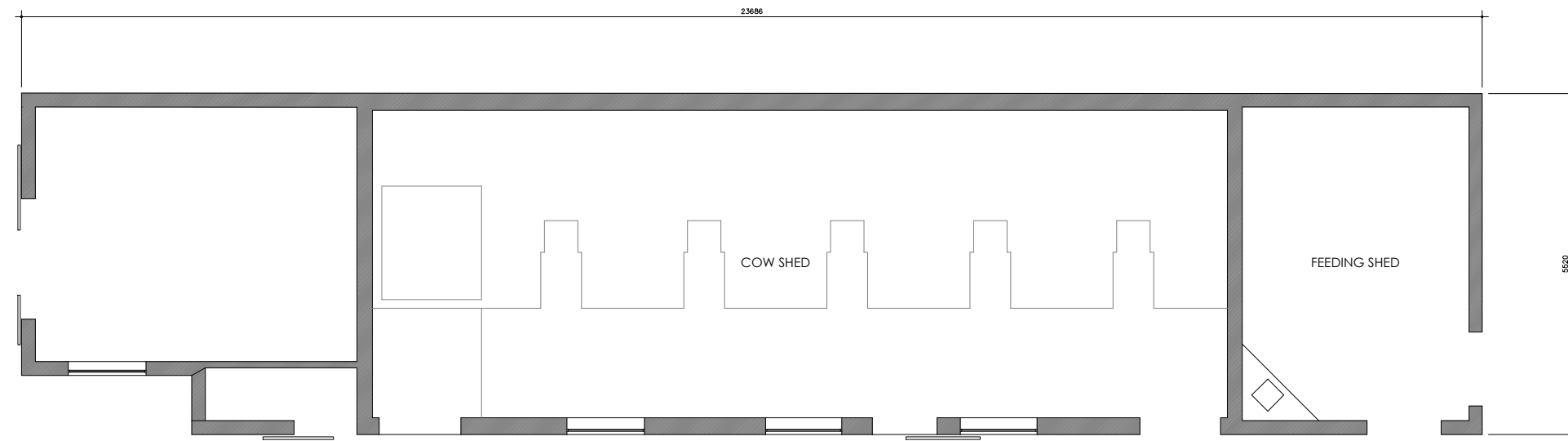

EXISTING FLOOR PLAN



Residential - Agricultural - Commercial

Project	Proposed Agricultural Building Conversion (Old Dairy)		
Drawing Title	Existing Plan		
Location	Top House Farm, Arowry, Wrexham, SY13 3EQ		
Client	Mr T Hanmer		
Scale	1:100 @ A3		
Drawing No	75171 / GH / 100	Rev	-
Drawn By	NB	Date	2024/10/18

MERCIAN HOUSE, 9 DARWIN COURT, OXON
 BUSINESS PARK, SHREWSBURY, SY3 5HJ
 Tel: 01743 791336
 E-mail: mail@rogerparry.net
 Web address: www.rogerparry.net
Roger Parry & Partners LLP partnership no.OC312203
 Registered in England and Wales.
 A list of members of the LLP is available at the above address.