

MATERIAL KEY

-  Brick: Weinerberger Cassandra Multi Facing Brick
-  Timber Cladding: Vertical Board on Board Larch Cladding
-  Roof: Passaro SS52H Heavy Spanish Natural Slate in Blue/Grey
-  Windows & Doors: UPVC Agate Grey
-  WoodStone Estella House Sparrow Box
-  Vivara Pro Build-in WoodStone Bat Box
-  Grass
-  Tobermore Hard-Wearing Permeable Paving Blocks 200x100x60mm
-  Tobermore Classica Anti-Slip Permeable Paving Flags 450x450x35mm

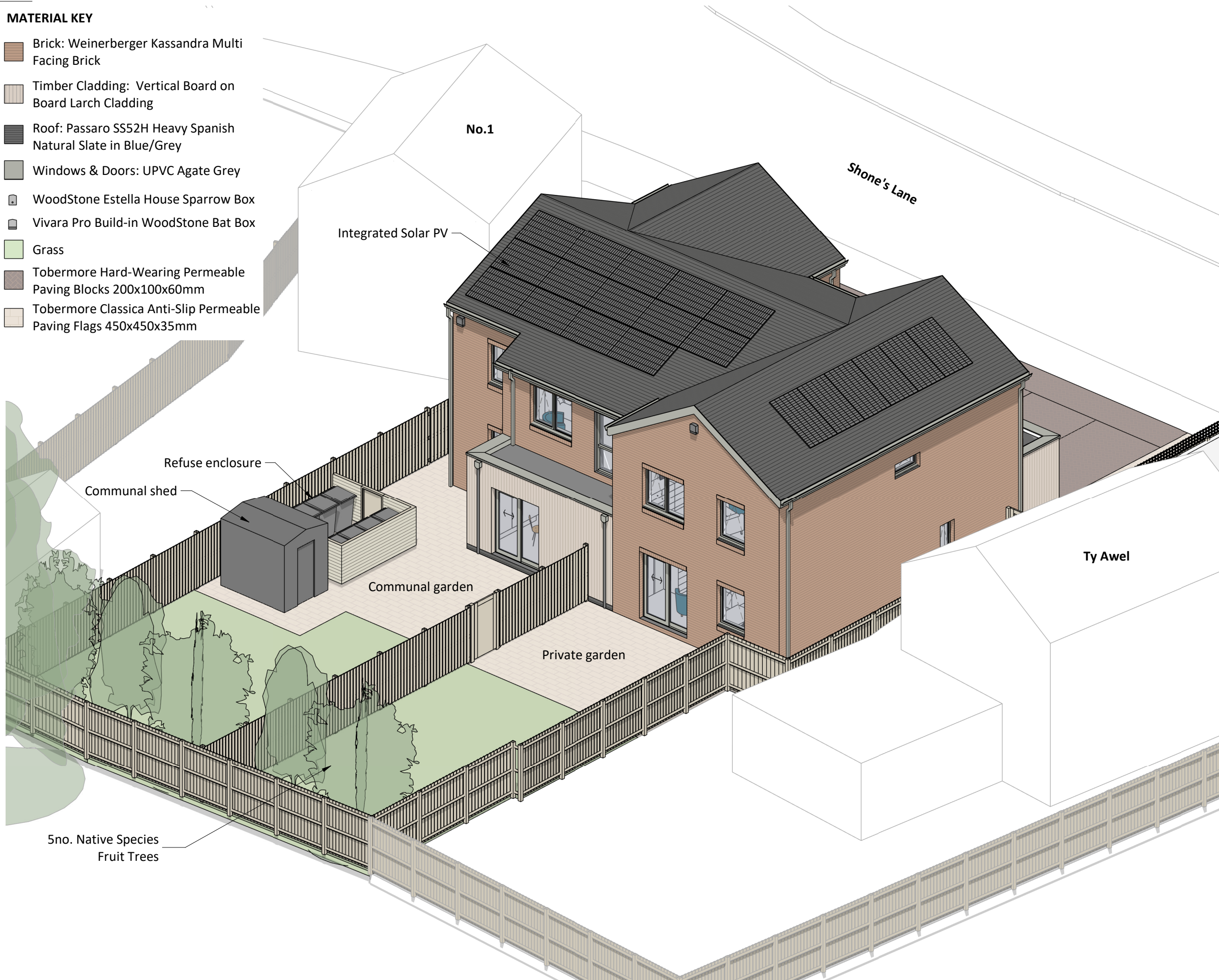

E	SCHEME REVISED FOLLOWING LPA FEEDBACK	30.01.25	ED
D	UNIT 4 AMENDED	23.10.24	ED
C	MATERIAL KEY ADDED	03.04.24	ED
B	REVISED DESIGN	23.02.24	ED
A	REVISED DESIGN	24.01.24	ED

REV	DESCRIPTION	DATE	BY
-----	-------------	------	----

THIS DRAWING IS THE COPYRIGHT OF AINSLEY GOMMON ARCHITECTS. CHECK ALL DIMENSIONS ON SITE. DISCREPANCIES TO BE NOTIFIED TO ARCHITECT. ELEMENTS OF STRUCTURE SHOWN ARE INDICATIVE AND FOR GUIDANCE. FINAL DESIGN TO BE AS STRUCTURAL ENGINEERS DETAILS AND SPECIFICATION.

PROJECT
COOP SITE - WREXHAM
 for FIRST CHOICE HOUSING

DRAWING TITLE
PROPOSED 3D VIEW 3

SCALE	DATE	DRAWN	CHECKED
1 : 100 @A3	22.11.2023	ED	SV

DRAWING STATUS
PLANNING

JOB No	DRAWING No	REVISION
C1145	011	E



THE OLD POLICE STATION, 15 GLYNNE WAY, HAWARDEN, CH5 3NS
 Tel: 01244 537 100 | wales@agarchitects.co.uk | www.agarchitects.co.uk
 Ainsley Gomon Architects Ltd. Registered in England & Wales No. 4187948
 Registered Office: 1 Price Street, Hamilton Square, Birkenhead CH41 6JN